

Slabmate Under Concrete Slab Installation Instructions

When Slabmate is used under a concrete slab it greatly improves the thermal performance of the slab and prohibits thermal leakage.

INSTALLATION INSTRUCTIONS

1. Prepare the sub-grade accordingly
2. Line your slab area with damp proof course (polythene).
3. Butt the Slabmate sheets together on top of the DPC and tape joins. (Make sure the Slabmate sheets are not placed under any footings or thickenings for load bearing walls.)
4. Slabmate can be cut around any obstructions but needs to be sealed using appropriate sealants.
5. When the sheets are laid, put the required mesh chairs down and place the reinforcing mesh on top.
6. Follow up pouring the concrete and level accordingly.

Slabmate has a compressive strength of 70kPa.

Instructions are a guideline only and should be interpreted with consideration for the specific building application. Alternative installation methods may be used provided the airspaces adjacent to the Slabmate are maintained and the material is non load bearing. All penetrations must be effectively sealed to reduce any risk of damage caused by possible exposure to extreme radiant heat. Please contact Foilboard® Australia Pty Ltd for further information. Safe installation practices are encouraged at all times.

HANDING AND STORAGE

It is recommended that if the product is being stored for extended periods it should be kept clean and dry. Any moisture present between sheets should be dried to prevent potential oxidization and must not be stored with either foil surface in contact with any alkaline materials.

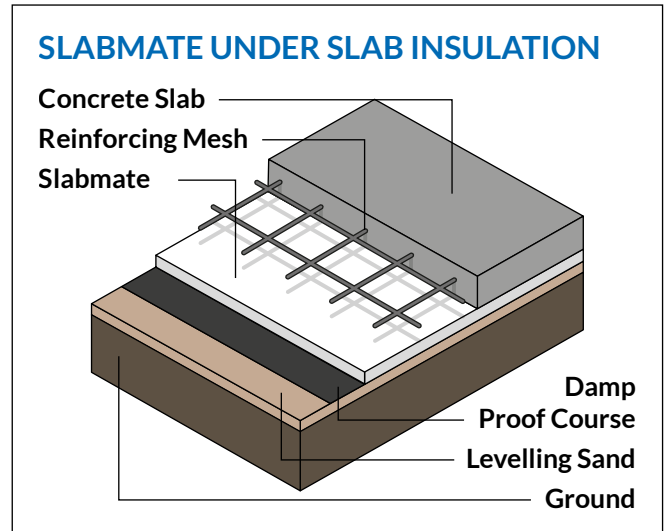

Diagram 1

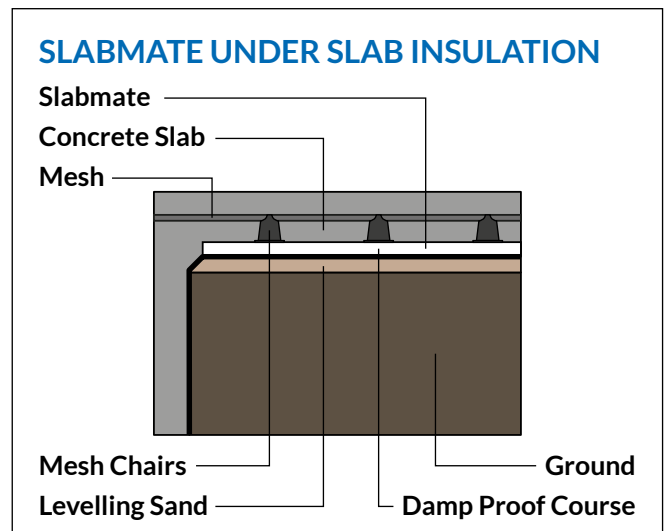

Diagram 2

SLABMATE

By the creators of Foilboard®

